

TERRIER SERIES SWING GATE OPENER

USER MANUAL

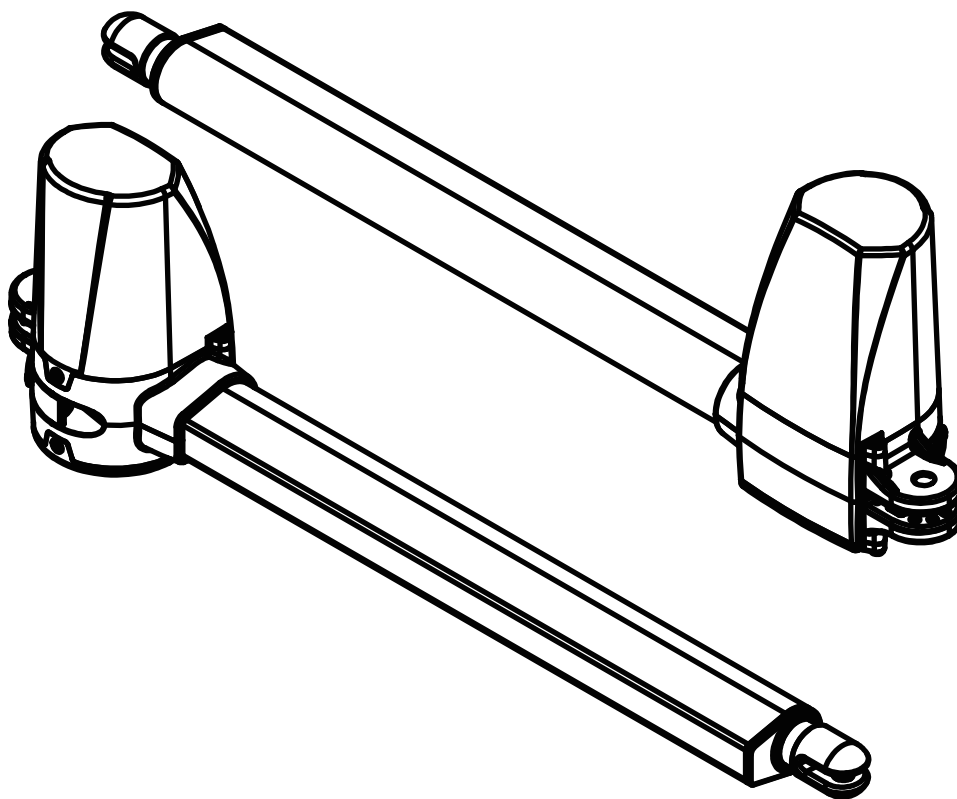

Reuse
Reduce
Recycle



INDEX

1.1	General Safety Precaution	P.1
1.2	Installation	P.2
	A. Standard Installation	P.2
	B. Dimension Chart	P.2
	C. Motor Fixing	P.3
	D. Wire Connection	P.3
	E. Emergency Release	P.4
1.3	Technical Features	P.4
	A. Dimension	P.4
	B. Technical Feature	P.5
1.4	Maintenance	P.5

1.1 GENERAL PRECAUTION:

WARNING :

This user manual is only for qualified technicians who is specialized in installations and automations.

- (1) All installations, electrical connections, adjustments and testing must be performed only after reading and understanding of all instructions carefully.
- (2) Before carrying out any installation or maintenance operation, disconnect the electrical power supply by turning off the magneto thermic switch connected upstream and apply the hazard area notice required by applicable regulations
- (3) Make sure the existing structure is up to standard in terms of strength and stability
- (4) When necessary, connect the motorized gate to reliable earth system during electricity connection phase.
- (5) Installation requires qualified personnel with mechanical and electrical skills.
- (6) Keep the automatic controls (remote, push bottom, key selectors...etc) being placed properly and away from children.
- (7) For replace or repair of the motorized system, only original parts must be applied. Any damage caused by inadequate parts and methods will not be claimed to motor manufacturer.
- (8) Never operate the drive if you have any suspect with what it might be faulty or damage to the system.
- (9) The motors are exclusively designed for the gate opening and closing application, any other usage is deemed inappropriate. The manufacture should not be liable for any damage resulting from the improper use. Improper usage should void all warranty, and the user accepts sole responsibility for any risks thereby may accrue.
- (10) The system may only be operated in proper working order. Always follow the standard procedures by following the instructions in this installation and operating manual.
- (11) Only command the remote when you have a full view of the gate.

TMT AUTOMATION INC. shall not be liable for any injury, damage, or any claim to any person or property which may result from improper use or installation of this system.

Please keep this installation manual for future reference.

1.2 STANDARD INSTALLATION

A STANDARD INSTALLATION

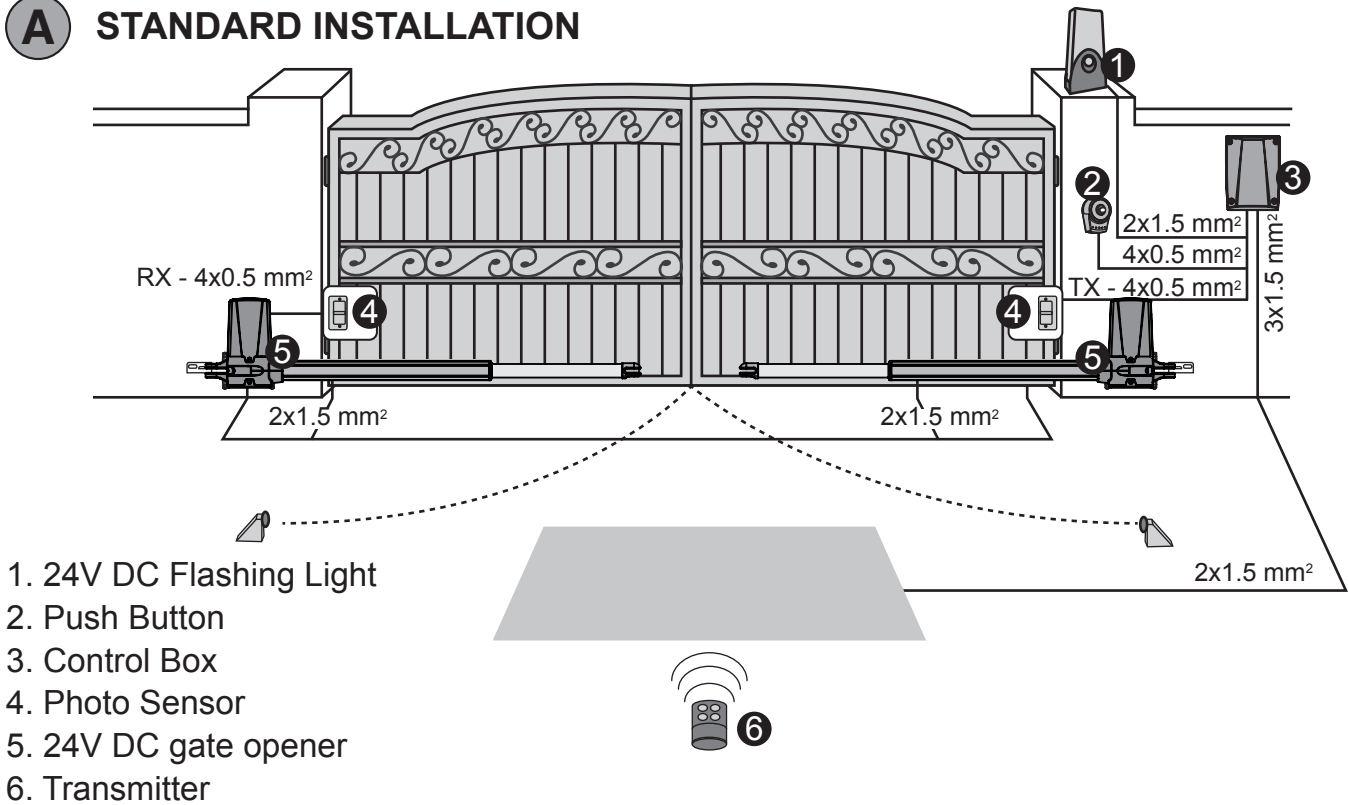

B DIMENSION CHART

Comply with the measures shown on the chart for proper installation. Adjust the gate structure to fit it for best automation, if necessary.

Before preceding the installation, be sure that gate moves freely and that:

- 1) Hinges are properly positioned and greased.
- 2) No obstacles in the moving area.
- 3) No frictions between two gate leafs or with the ground while moving

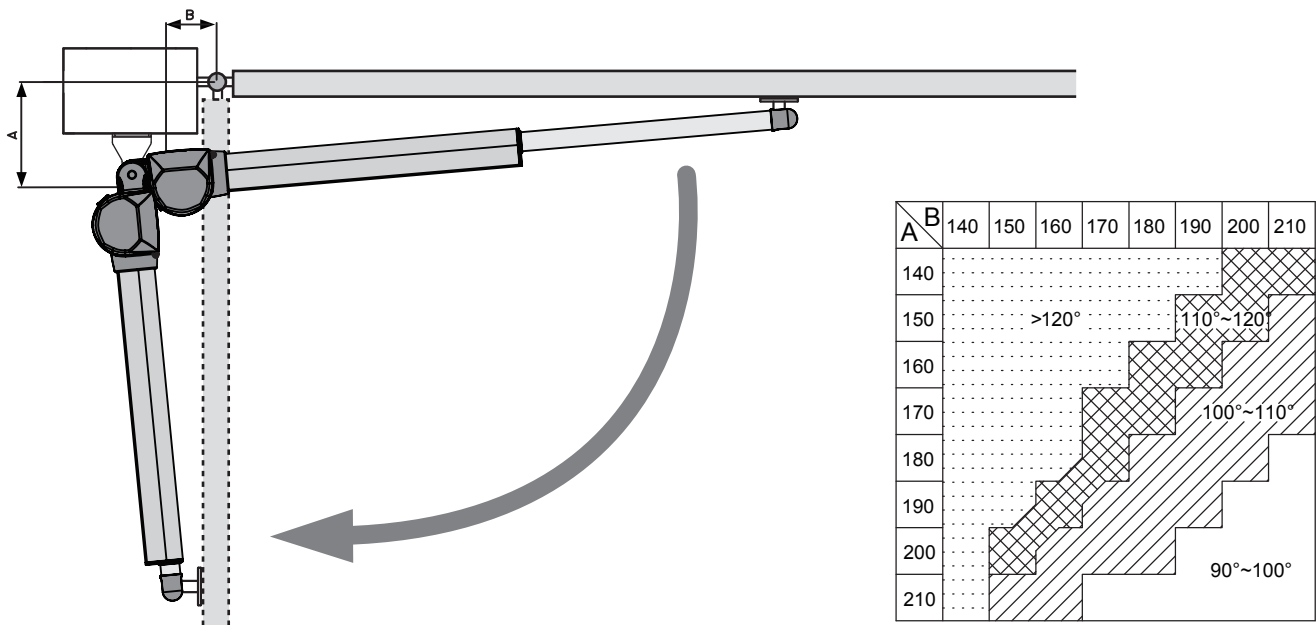

C MOTOR FIXING

Assemble the rear bracket and fix it on the pillar.

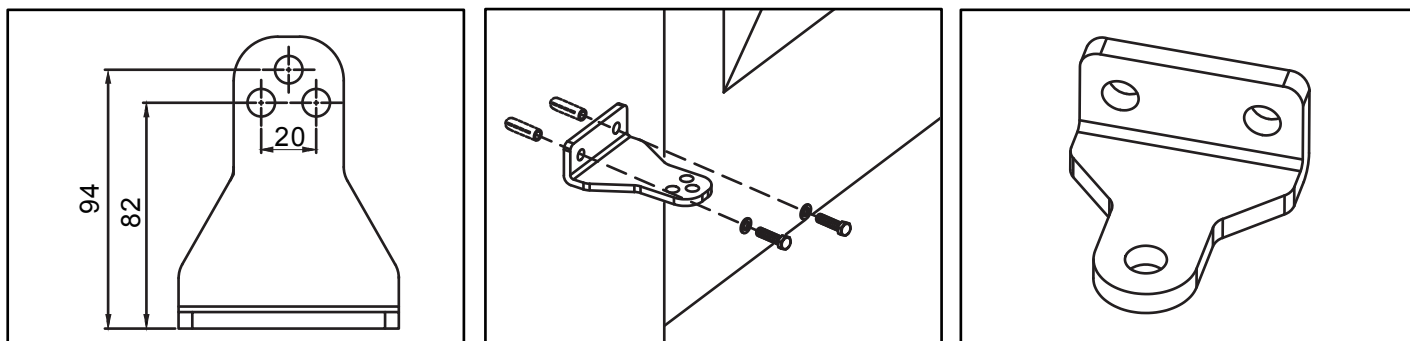

Release the gate opener and place the pin into the fitting position no.1 and no. 2

Make sure the gate openers are mounted in horizontal position especially in those positions.

1) Gate in “CLOSE” position

2) Gate in “OPEN” position

3) Gate at “45 ° angle” position

Prior to weld the bracket on the gate leaf(if necessary), cover the gate opener to prevent damages from sparks.

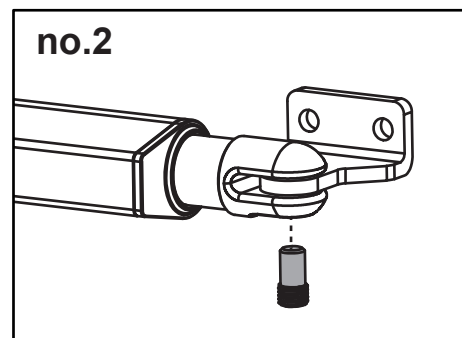
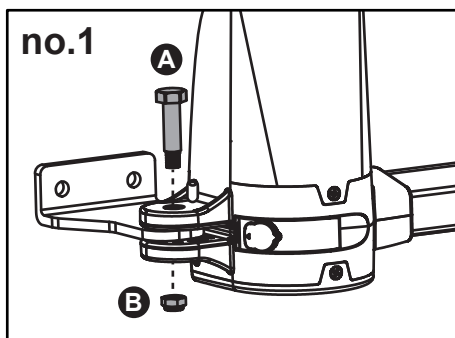
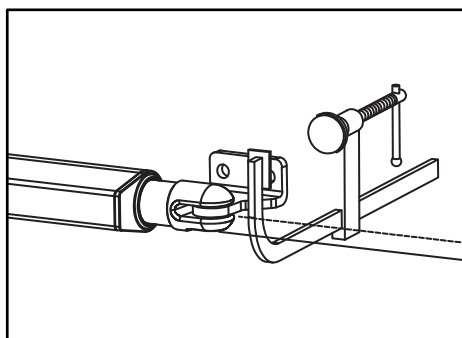

D WIRE CONNECTION:

①	White(+)	Motor
②	Yellow(-)	Motor
③	Red(5V)	Hall Sensor
④	Green(Signal)	Hall Sensor
⑤	Black(GND)	Hall Sensor

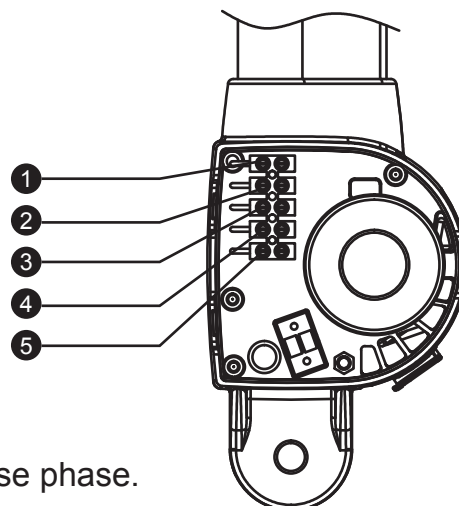

(1) Avoid tension in the cable during open and close phase.

(2) Always connect the grounding wire(GND)

E EMERGENCY RELEASE

Gear Motor Release (for left motor)

- 1). Insert the release key to the release slot
- 2). Turn the release key anti-clockwise
- 3). Pull out the release bar
- 4). Turn the release key clockwise to fix the release bar, the release bar has to be in pulled out position when you turn the release key clockwise
- 5). The turning direction will be reversed for right motor.

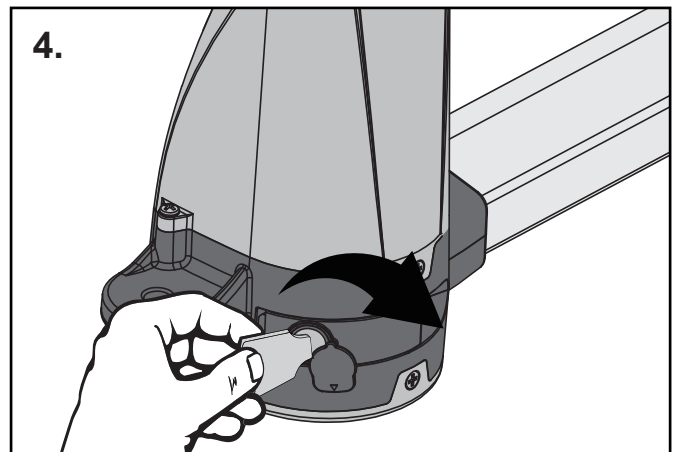
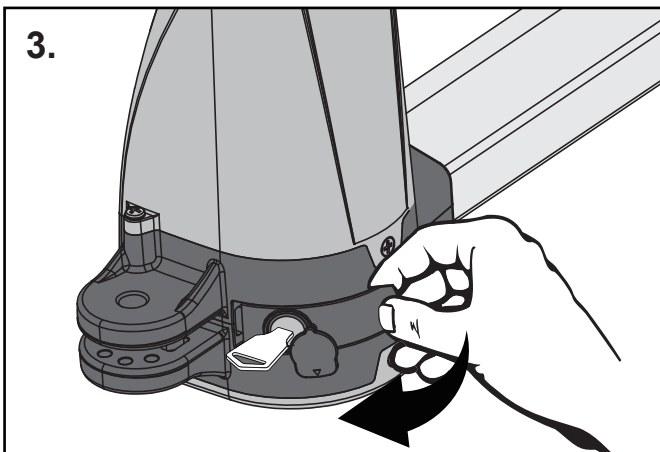
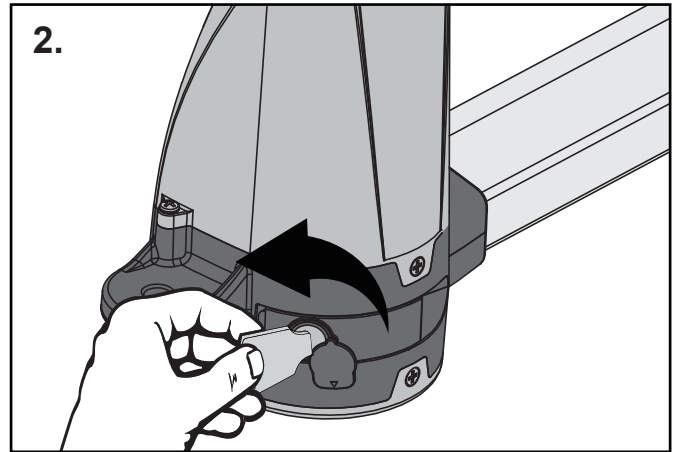
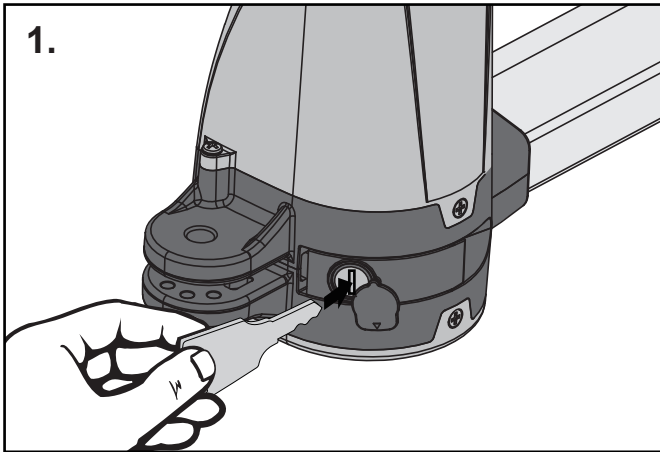

1.3 TECHNICAL FEATURES :

A Dimension:

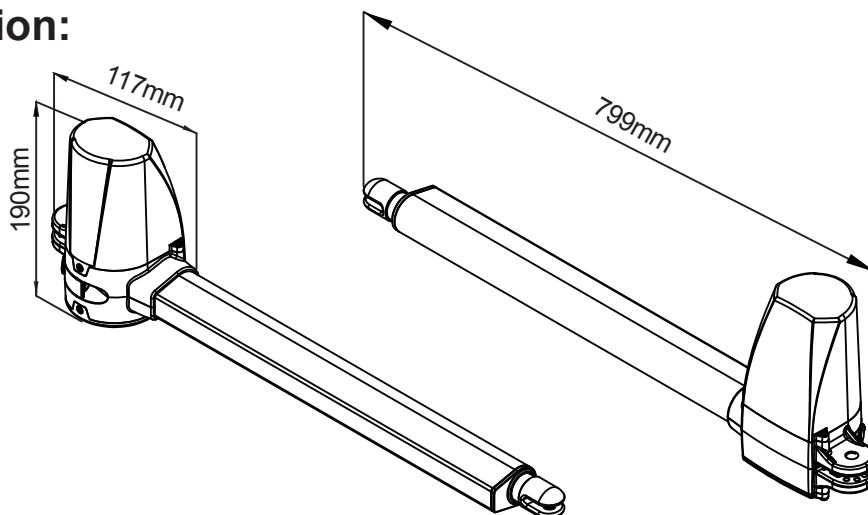

B Technical Feature:

Motor	24Vdc motor with mechanical release
Gear type	Worm gear
Thrust	2000N
Stroke length	400mm
Power supply	24Vdc
Maximum operating	4.2A for maximum 10 seconds.
Maximum gate weight	250 kg per leaf
Maximum gate length	2.5 meters
Duty cycle	20%
Operating Temperature	-20°C~+50°C
Dimension	799mm * 98mm * 170mm
Weight	3.6kg

1.4 Maintenance:

Conduct the following operations at least every 6 months. If in high intensity of use, shorten the period in between.

Disconnect the power supply:

- (1) Clean and lubricate the screws, the pins, and the hinge with grease.
- (2) Check the fastening points are properly tightened.
- (3) Make the wire connection are in good condition.

Connect the power supply:

- (1) Check the power adjustments.
- (2) Check the function of the manual release.
- (3) Check the function of photocells or other safety devise.



**24V power supply
for great safety**



**Solid material apply
with lasting usage**



**Manual release device
with easy use and
highly protection**



**Worm gear application
give silence operation**



**Easy installation
and user friendly
interface**